



LHM 0606/10 Ceiling Loudspeaker



The LHM 0606/10 is a general purpose 6 W cost-effective ceiling loudspeaker. It is clamp mounted into the ceiling. An optional fire dome is available.

Functions

An economic flushing-mounting ceiling loudspeaker is available for general purpose applications. This full range loudspeaker is suitable for both speech and music reproduction in shops, department stores, schools, offices, sports halls, hotels and restaurants.

The speaker assembly consists of a single-piece, 6W dual cone loudspeaker and frame, with a 100V matching transformer mounted on the back. A circular metal grille is an integrated part of the front. The appearance and neutral white color has been selected to be unobtrusive in virtually all interiors.

Certifications and Approvals

| | |
|-------------------------|------------------------|
| Safety | acc. to EN 60065 |
| Acoustic specifications | according to IEC 268.5 |

- ▶ Suitable for speech and music reproduction
- ▶ Flush-mounting in ceiling cavity
- ▶ Easy to install
- ▶ Simple power setting
- ▶ Optional certified fire dome mounting
- ▶ Unobtrusive in virtually all interiors
- ▶ Complies with international installation and safety regulations

Installation/Configuration Notes

Mounting

The assembly can be simply and quickly installed into a hole in the ceiling cavity and secured by two integral spring-loaded ceiling locking clamps. A circular template for marking a 165 mm diameter hole is included with the loudspeaker.

Three lead wires are provided on the matching transformer (Primary) to allow selection of nominal full-power, half-power or quarter-power radiation.

Fire dome

During a fire, the ceiling cavity in which loudspeakers are installed can allow flames to spread throughout a building. To prevent fire entering the cavity via the loudspeaker, the ceiling loudspeaker can be fitted with a protective steel fire dome LBC 3080/01.

This optional fire dome is mounted on the loudspeaker assembly using four self-tapping screws, supplied as standard. There are four knock-out holes; two (2) for rubber grommets (supplied) and two (2) for cable glands. (PG13).

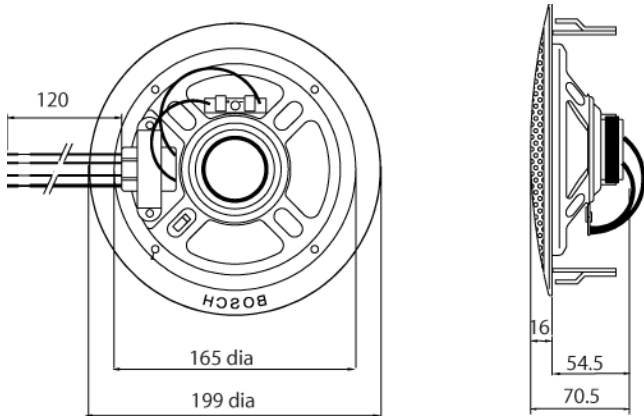

Dimensions (inmm)

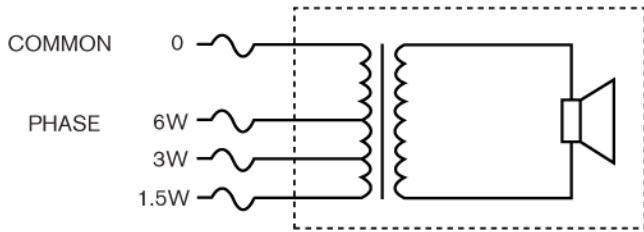

Circuit diagram

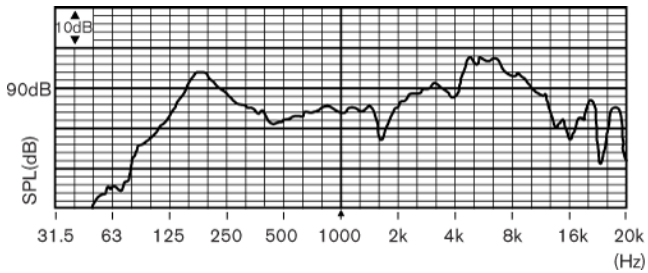

Frequency response

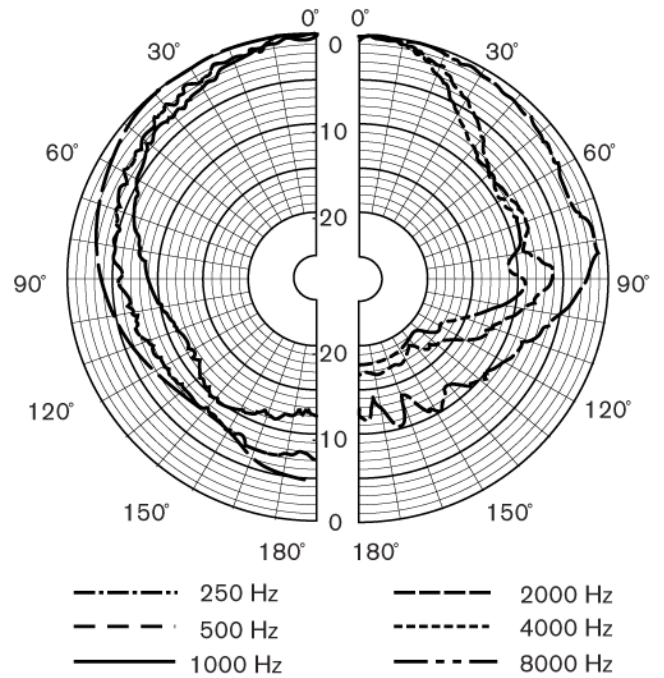

Polar diagram (measured with pink noise)

LBC 3080/01 Fire Dome (optional)



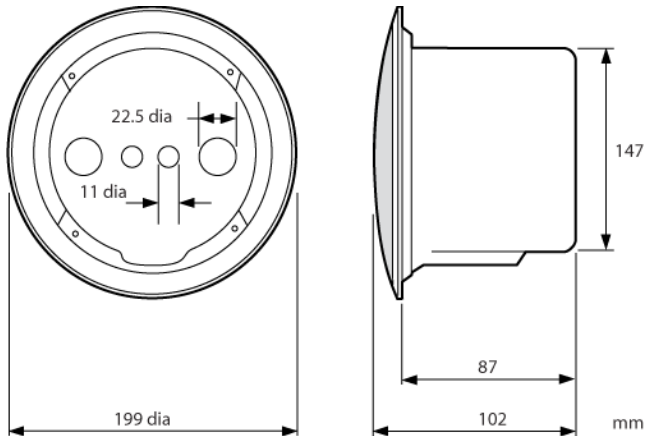

LHM 0606/10 + LBC 3080/01 Fire dome assembly dimensions

Parts Included

| Quantity | Component |
|----------|---------------------------------|
| 1 | LHM 0606/10 Ceiling Loudspeaker |

Technical Specifications

Electrical

LHM 0606/10

| | |
|---|--------------------|
| Max. Power | 9 W |
| Rated Power (PHC) | 6 W (6-3-1.5 W) |
| Sound Pressure Level at 6W/1W (at 1kHz, 1 m) | 92 dB/ 84 dB (SPL) |
| Effective Frequency Range (-10 dB) | 80 Hz to 18 kHz |
| Opening Angle (at 1 kHz/4 kHz, -6 dB) | 175° / 55° |
| Rated Voltage | 100 V |
| Rated Impedance | 1667 ohm |

Mechanical

| | |
|-------------------------------|-------------------|
| Speaker Size | 152.4 mm (6 inch) |
| Dimensions (dia x max. depth) | 199 x 70.5 mm |
| Mounting Cut-Out Dia. | 165 mm |
| Color | White (RAL 9010) |
| Weight | 620 g |

Environmental

| | |
|---------------------|---------------|
| Ambient Temperature | -25° to +55°C |
|---------------------|---------------|

LBC 3080/01 Fire Dome

| | |
|-------------------------------|------------------|
| Dimensions (dia x max. depth) | 147 x 87 mm |
| Certified B15 | acc. to DIN 4102 |
| Color | White (RAL 9010) |
| Weight | 360 g |

Ordering Information

Model | Description

LHM 0606/10 Ceiling Loudspeaker

Hardware Accessories

LBC 1256/00 EVAC Connection Adapter
3-pole screw connector (100 pcs)

LBC 3080/01 Fire Dome

Americas:
Bosch Security Systems
130 Perinton Parkway
Fairport, New York, 14450, USA
Phone: +1 585 223 4060
Fax: +1 800 289 0096
security.sales@us.bosch.com
www.boschsecurity.us

Europe, Middle East, Africa:
Bosch Security Systems B.V.
P.O. Box 80002
5600 JB Eindhoven, The Netherlands
Phone: +31 (0) 40 27 83955
Fax: +31 (0) 40 27 86668
emea.securitysystems@bosch.com
www.boschsecurity.com

Asia-Pacific:
Bosch Security Systems Pte Ltd
38C Jalan Pemimpin
Singapore 577180
Phone: +65 6319 3450
Fax: +65 6319 3499
apr.securitysystems@bosch.com
www.boschsecurity.com

Represented by